

Fig. 1

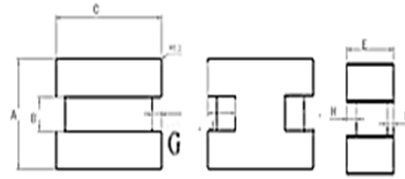

Fig. 2

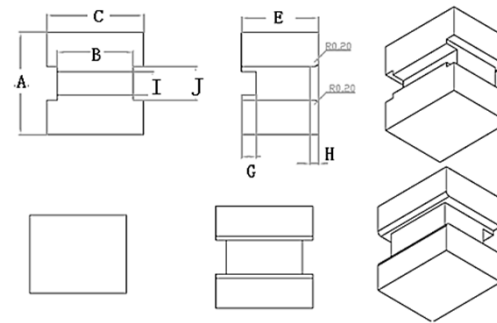

Fig. 3

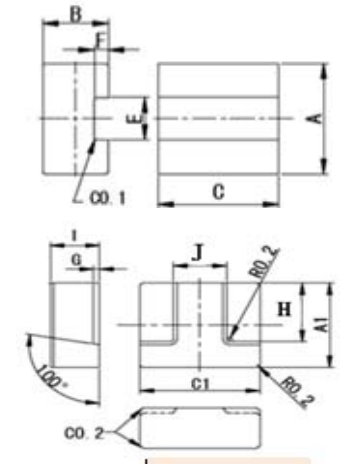

Fig. 4

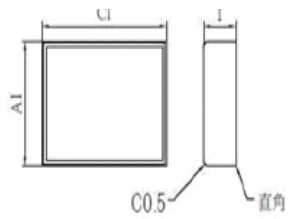

Fig. 5

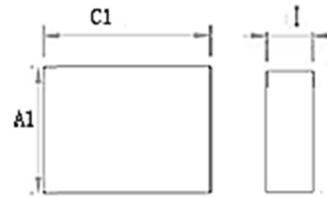

Fig. 6

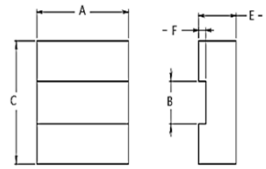

Fig. 7

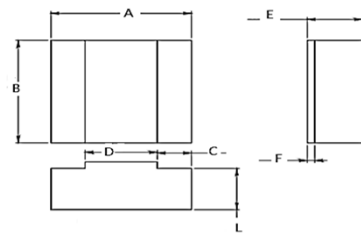
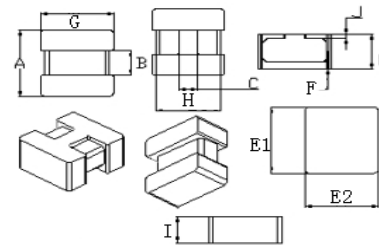

Fig. 8



## C1型

尺寸Dim 型号 Type	图形 Fig.	A=A1 (mm)	B (mm)	C=C1 (mm)	H (mm)	G (mm)	F (mm)	E1 (mm)	E2 (mm)	E (mm)	J (mm)	I (mm)
C13.8/3.5	7	3.8±0.15	1.5±0.15	0.9±0.15	3.2±0.15	3.5±0.15	0.35±0.1	3.8±0.15	3.5±0.15	1.8±0.1	0.2±0.1	1.7±0.1
C16.0/7.0	8	6.0±0.15	3.2±0.10 1.7±0.10	5.1±0.15	3.2±0.1	7.0±0.15	0.95±0.1	—	—	4.0±0.1	3.2±0.1	—
C16.55/7.0	2	6.55+0.15/-0.1	2.35±0.08	7±0.15	—	0.25±0.05	0.325+0.1/-0.05	1.125±0.075	—	2.35±0.08	—	1.5±0.08
C16.8	2	6.8±0.1	3.4±0.15	9.3±0.15	0.65±0.1	0.65REF	0.55±0.05	—	—	3.1±0.08	—	—
C17.1X10	1	7.1±0.15	4.45±0.1	10.0±0.15	8.8±0.15	0.5±0.07	0.9±0.07	2.0±0.1	2.8±0.1	—	—	2.6±0.15
C17.85X10.45	2	7.85±0.2	2.4±.1	10.45±0.2	0.9±0.1	0.9±0.1	0.6REF	—	—	4.6±0.1	2.75±0.1	3.0±0.1

C19.8*7.65	2	7.65±0.1	2.4±.1	9.8±0.1	0.55±0.05	—	0.4±0.05	—	—	3.6±0.1	2.5±0.1	3.4±0.1
C19.9-7.7-C	5	9.9±0.15	2.6+0.12/-0.08	7.7±0.12	—	—	0.45+0.08/-0.05	—	—	2.45+0.05/-0.1	—	—
C19.9-7.7-I	5	9.86±0.2	7.65±0.15	2.06REF	—	—	0.2±0.08	—	—	2.15±0.1	—	—
C14.85/4.65	3		3.65±0.15	4.65±0.15	0.4±0.1	0.7±0.1	—	2.4±0.1	—	3.7±0.1	1.6±0.1	1.1±0.1
C17.3/9.5	4	7.3±0.1	3.7±0.1	9.5±0.1	4.5±0.15	0.55±0.1	0.75±0.1	—	—	2±0.1	4.2 REF	3.3±0.1
C110.1 注：1片同Fig.1	4	10.1±0.15	3.6±0.1	C:9.0±0.15 C1: 10.1±0.15	—	—	0.6±0.1	—	—	3.2±0.1	—	3.0±0.1
C113.8	1	10.5±0.2	4.4±0.1	13.8±0.2	12.6±0.15	0.5±0.1	0.95±0.15	2.8±0.2	—	—	—	—